

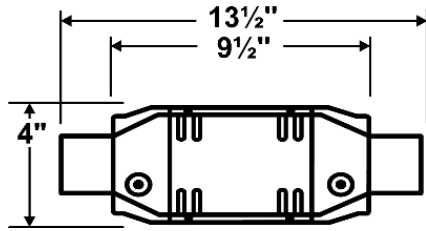

Universal XL 4" Round Short Body

P/N 650384

Load: XL (Federal eXtra Load)
Inlet ID: 2.0"
Outlet ID: 2.0"
Dual O² Sensor Ports



P/N 650385

Load: XL (Federal eXtra Load)
Inlet ID: 2.25"
Outlet ID: 2.25"
Dual O² Sensor Ports

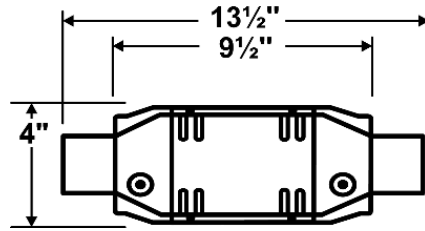

P/N 650386

Load: XL (Federal eXtra Load)
Inlet ID: 2.5"
Outlet ID: 2.5"
Dual O² Sensor Ports

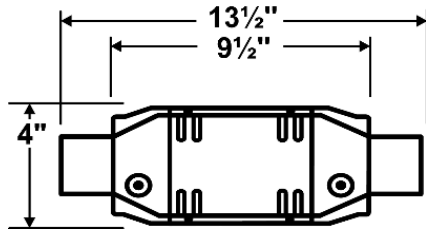

Universal XL 7" Standard Oval Body

P/N 650205

Load: XL (Federal eXtra Load)
Inlet ID: 2.25"
Outlet ID: 2.25"
No O² Ports or Air tubes

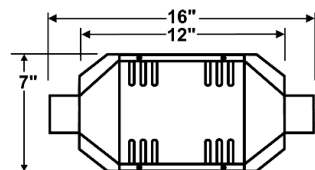

P/N 650206

Load: XL (Federal eXtra Load)
Inlet ID: 2.5"
Outlet ID: 2.5"
No O² Ports or Air tubes

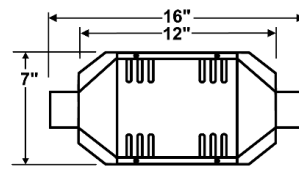

Disturbing the Peace Since 1968

2400 Maremont Parkway – Loudon, TN 37774
800-882-6833 – www.cherrybomb.com – 800-445-7616

3/2/2010



Universal XL 7" Standard Oval Body

P/N 650209

Load: XL (Federal eXtra Load)
Inlet ID: 3.0"
Outlet ID: 3.0"
No O² Ports or Air tubes

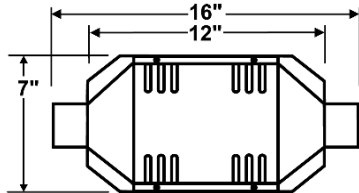

P/N 650234

Load: XL (Federal eXtra Load)
Inlet ID: 2.0"
Outlet ID: 2.0"
O² Sensor Ports

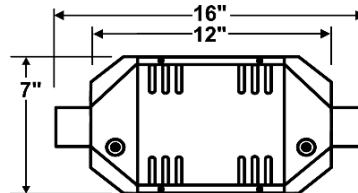

P/N 650235

Load: XL (Federal eXtra Load)
Inlet ID: 2.25"
Outlet ID: 2.25"
Dual O² Sensor Ports

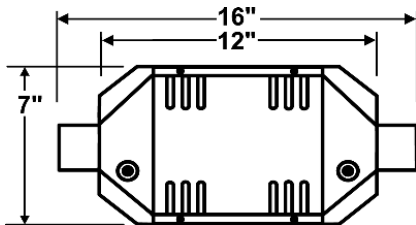

P/N 650236

Load: XL (Federal eXtra Load)
Inlet ID: 2.5"
Outlet ID: 2.5"
Dual O² Sensor Ports

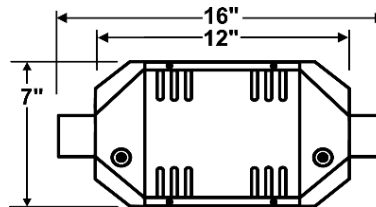

P/N 650239

Load: XL (Federal eXtra Load)
Inlet ID: 3.0"
Outlet ID: 3.0"
Dual O² Sensor Ports

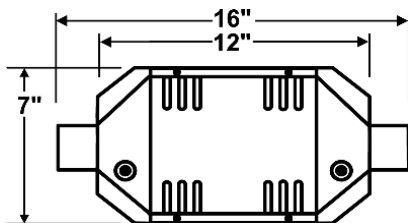

P/N 650273

Load: XL (Federal eXtra Load)
Inlet ID: Dual 2.0"
Outlet ID: 2.5"
Dual O² Sensor Ports

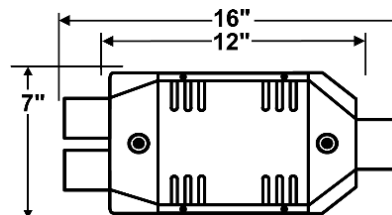



Universal XXL 4" Round Short Body

P/N 653384

Load: XXL (Federal XXL Load)
Inlet ID: 2.0"
Outlet ID: 2.0"
Dual O² Sensor Ports

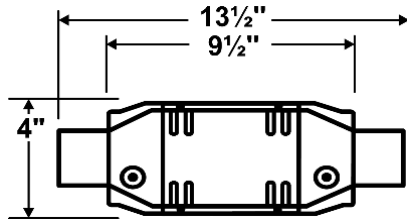

P/N 653385

Load: XXL (Federal XXL Load)
Inlet ID: 2.25"
Outlet ID: 2.25"
Dual O² Sensor Ports

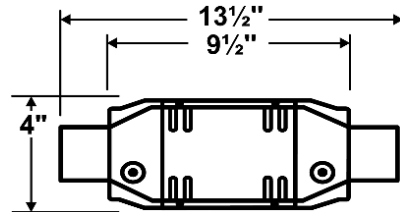

P/N 653386

Load: XXL (Federal XXL Load)
Inlet ID: 2.5"
Outlet ID: 2.5"
Dual O² Sensor Ports

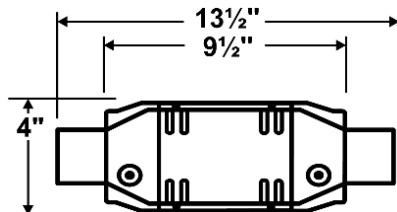

Universal XXL 4" Round Standard Body

P/N 653381

Load: XXL (Federal XXL Load)
Inlet ID: 2.25"
Outlet ID: 2.25"
Mid-Bed O² Sensor Port

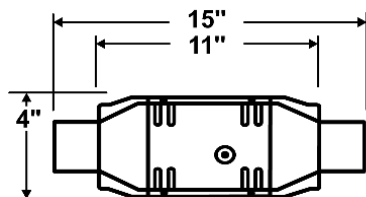

P/N 653382

Load: XXL (Federal XXL Load)
Inlet ID: 2.5"
Outlet ID: 2.5"
Mid-Bed O² Sensor Port

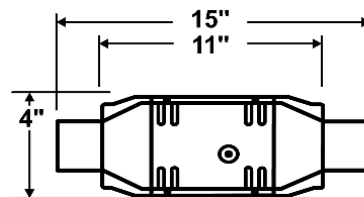

Disturbing the Peace Since 1968

2400 Maremont Parkway – Loudon, TN 37774
800-882-6833 – www.cherrybomb.com – 800-445-7616

3/2/2010



Universal XXL 4" Round Long Body

P/N 653344

Load: XXL (Federal XXL Load)
Inlet ID: 2.0"
Outlet ID: 2.0"
Dual O² Sensor Ports

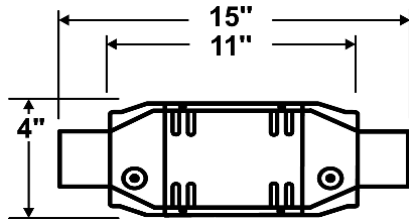

P/N 653345

Load: XXL (Federal XXL Load)
Inlet ID: 2.25"
Outlet ID: 2.25"
Dual O² Sensor Ports

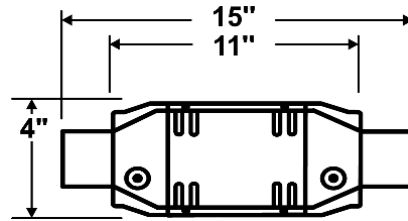

P/N 653346

Load: XXL (Federal XXL Load)
Inlet ID: 2.5"
Outlet ID: 2.5"
Dual O² Sensor Ports

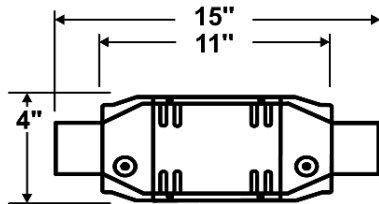

Universal XXL 6 1/2" Standard Oval Short Body

P/N 653124

Load: XXL (Federal XXL Load)
Inlet ID: 2.0"
Outlet ID: 2.0"
No O² Ports or Air tubes

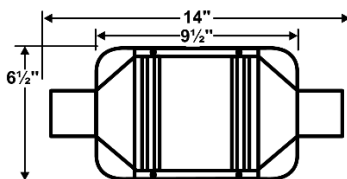

P/N 653125

Load: XXL (Federal XXL Load)
Inlet ID: 2.25"
Outlet ID: 2.25"
No O² Ports or Air tubes

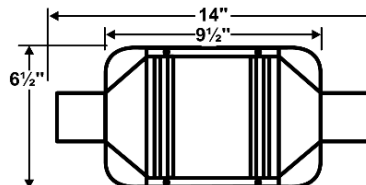

Disturbing the Peace Since 1968

2400 Maremont Parkway – Loudon, TN 37774
800-882-6833 – www.cherrybomb.com – 800-445-7616

3/2/2010



Universal XXL 6 1/2" Standard Oval Short Body

P/N 653126

Load: XXL (Federal XXL Load)
Inlet ID: 2.5"
Outlet ID: 2.5"
No O² Ports or Air tubes

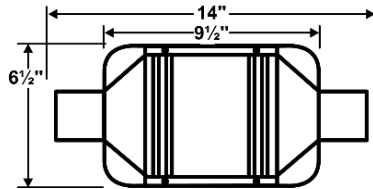

P/N 653144

Load: XXL (Federal XXL Load)
Inlet ID: 2.0"
Outlet ID: 2.0"
Dual O² Sensor Ports

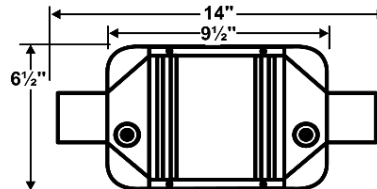

P/N 653145

Load: XXL (Federal XXL Load)
Inlet ID: 2.25"
Outlet ID: 2.25"
Dual O² Sensor Ports

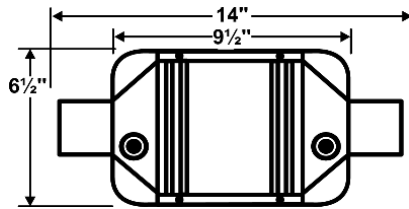

P/N 653146

Load: XXL (Federal XXL Load)
Inlet ID: 2.5"
Outlet ID: 2.5"
Dual O² Sensor Ports

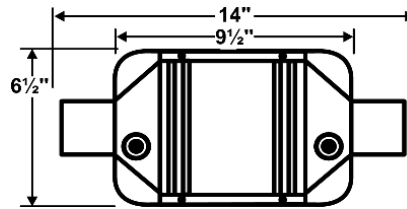

Universal XXL 6 1/2" Standard Oval Long Body

P/N 653004

Load: XXL (Federal XXL Load)
Inlet ID: 2.0"
Outlet ID: 2.0"
No O² Ports or Air tubes

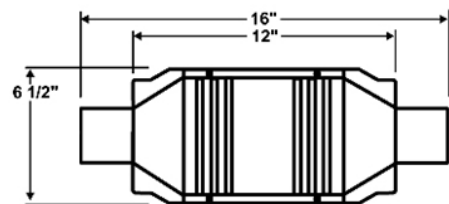

P/N 653005

Load: XXL (Federal XXL Load)
Inlet ID: 2.25"
Outlet ID: 2.25"
No O² Ports or Air tubes

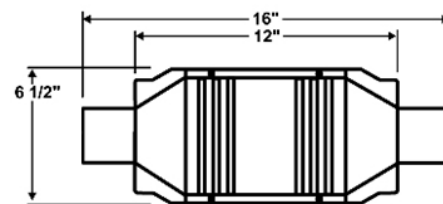

Disturbing the Peace Since 1968

2400 Maremont Parkway – Loudon, TN 37774
800-882-6833 – www.cherrybomb.com – 800-445-7616

3/2/2010



Universal XXL 6 1/2" Standard Oval Long Body

P/N 653006

Load: XXL (Federal XXL Load)
Inlet ID: 2.5"
Outlet ID: 2.5"
No O² Ports or Air tubes

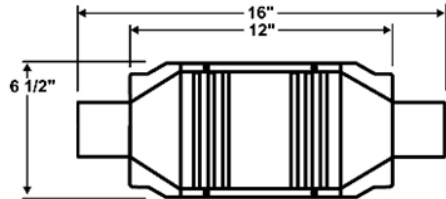

P/N 653009

Load: XXL (Federal XXL Load)
Inlet ID: 3.0"
Outlet ID: 3.0"
No O² Ports or Air tubes

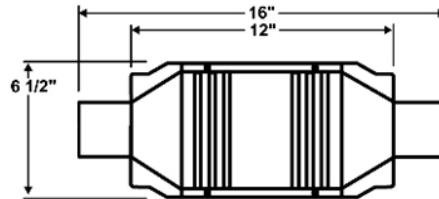

P/N 653034

Load: XXL (Federal XXL Load)
Inlet ID: 2.0"
Outlet ID: 2.0"
Single O² Sensor Port

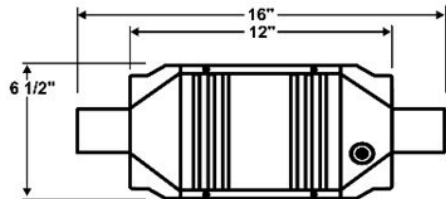

P/N 653035

Load: XXL (Federal XXL Load)
Inlet ID: 2.25"
Outlet ID: 2.25"
Single O² Sensor Port

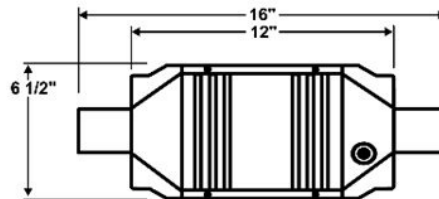

P/N 653036

Load: XXL (Federal XXL Load)
Inlet ID: 2.5"
Outlet ID: 2.5"
Single O² Sensor Port

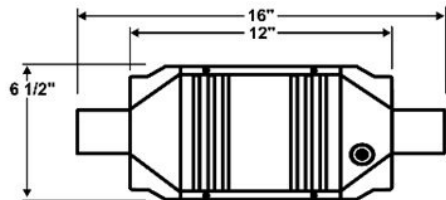

P/N 653039

Load: XXL (Federal XXL Load)
Inlet ID: 3.0"
Outlet ID: 3.0"
Single O² Sensor Port

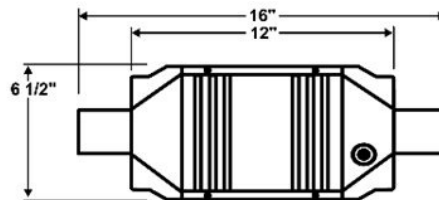



Universal XXL 6 1/2" Standard Oval Long Body

P/N 653024

Load: XXL (Federal XXL Load)
 Inlet ID: 2.0"
 Outlet ID: 2.0"
 Dual O² Sensor Ports

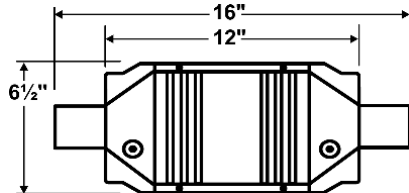

P/N 653025

Load: XXL (Federal XXL Load)
 Inlet ID: 2.25"
 Outlet ID: 2.25"
 Dual O² Sensor Ports

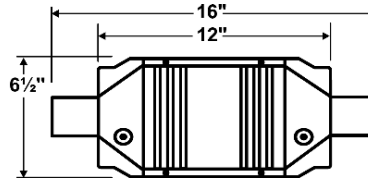

P/N 653026

Load: XXL (Federal XXL Load)
 Inlet ID: 2.5"
 Outlet ID: 2.5"
 Dual O² Sensor Ports

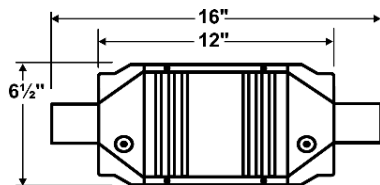

P/N 653029

Load: XXL (Federal XXL Load)
 Inlet ID: 3.0"
 Outlet ID: 3.0"
 Dual O² Sensor Ports

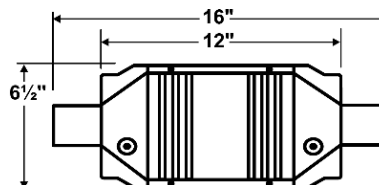

Universal XXL 6 1/2" Oval Angled Body

P/N 653184

Load: XXL (Federal XXL Load)
 Body Width: 6.5"
 Body Length: 9.0"
 Overall Length: 13.0"
 Inlet ID: 2.0"
 Outlet ID: 2.0"
 No O² Ports or Air tubes

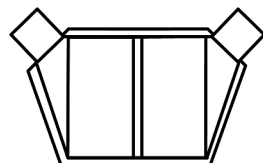

P/N 653185

Load: XXL (Federal XXL Load)
 Body Width: 6.5"
 Body Length: 9.0"
 Overall Length: 13.0"
 Inlet ID: 2.25"
 Outlet ID: 2.25"
 No O² Ports or Air tubes

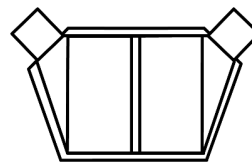



Universal XXL 7" Wide Oval Long Body

P/N 653236

Load: XXL (Federal XXL Load)
Inlet ID: 2.5"
Outlet ID: 2.5"
Dual O² Sensor Ports

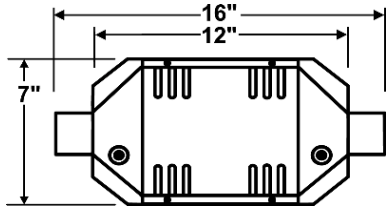

P/N 653932

Load: XXL (Federal XXL Load)
Inlet ID: Dual 2.0"
Outlet ID: Dual 2.0"
Single O² Sensor Port

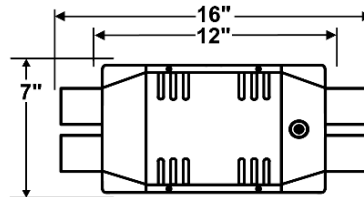

Universal XXL 7" Wide Oval Angled/Straight Body

P/N 653184

Load: XXL (Federal XXL Load)
Body Width: 6.5"
Body Length: 9.0"
Overall Length: 13.0"
Inlet ID: 2.25"
Outlet ID: 2.25"
No O² Ports or Air tubes

