

2005 Buick Truck Rendezvous AWD V6-3.4L VIN E

[Vehicle Level](#) → [Technical Service Bulletins](#) → [All Technical Service Bulletins](#) → [Drivetrain - Boom or Drone Noise at 2100 RPM](#) ←

Drivetrain - Boom or Drone Noise at 2100 RPM

[Notes](#)

Bulletin No.: 04-04-17-001B

Date: June 29, 2007

TECHNICAL

Subject:

Boom or Drone Noise at 2100 rpm or About 120 km/h (75 mph)
(Inspect and Clean [Torque Tube](#) Mount or Install Dampener/Mount Kit)

Models:

2002-2004 Buick Rendezvous AWD
2005 Buick Rendezvous AWD (w/LA1 Only)
2002-2005 Chevrolet Venture AWD
2002-2003 Oldsmobile Silhouette AWD
2002-2005 Pontiac Aztek AWD, Montana AWD

Supercede:

This bulletin is being revised to add a corrective action, one illustration and warranty information. Please discard Corporate Bulletin Number 04-04-17-001A. (Section 04 - Driveline/Axle).

Condition

Some customers may comment on a noise or vibration that can be heard centered at or around 2100 RPM. This usually occurs at about 120 km/h (75 mph) in 4th gear, but the sound may be audible in all gears when at 2100 RPM.

Cause

The central [torque tube](#) mount, dampener and bushing may be allowing noise and/or engine vibration to transfer to the body at the mount point.

Correction # 1

ALWAYS inspect and if required perform Correction # 1 BEFORE going on to Correction # 2.

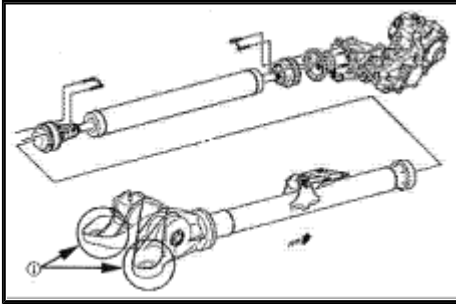
[Zoom](#)[Sized for Print](#)

Vehicles that have been operated on dirt roads or in loose dirt may experience a condition called "mud packing". If a large quantity of dirt accumulates on the center torque-tube mount, noise and/or vibration may be transmitted to the passenger compartment. The illustration above highlights the areas of concern within the circles. Please inspect and thoroughly clean the areas indicated if required. If a quantity of dirt was found on the mount, please road test the vehicle and confirm that the boom or drone noise has been corrected. If the noise remains, continue with Correction # 2.

Correction # 2

A kit has been developed that includes a revised torque-tube mount, spacing washer and a new dampener. Use the procedure below to install these revised parts.

Raise and suitably support the vehicle.

You must support the [torque tubes](#) near the central torque tube coupling. Do not let the shafts hang under their own weight.



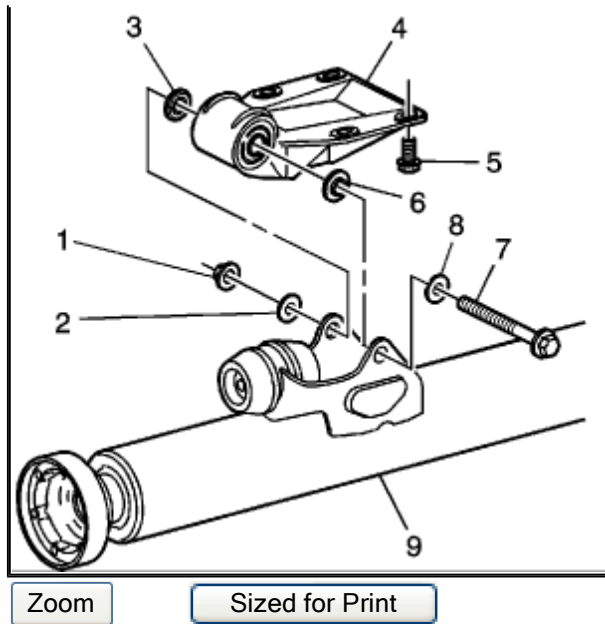

Zoom

Sized for Print

Place a jackstand under the rear torque-tube near the coupling. Place the jackstand to suitably support the driveshafts.

Loosen the throughbolt (7) holding the [torque tubes](#) to the mount until the nut comes off the bolt. This is a T-47 TORX(R) bolt with a nut (3) on the other end. You will need to hold both ends of the fastener in order to remove the nut. Do not remove the bolt at this point.

Do not let the nut fall into the welded on bracket of the [torque tube](#). If the loose nut is allowed to remain, it may cause a rattle audible in the passenger compartment.

Remove the four bolts (5) retaining the [torque tube](#) mount (4) to the floorpan of the vehicle.

Now that the mount is loose, you will be able to slightly raise the [torque tubes](#) (9). This will allow you to remove the throughbolt from the mount by pulling it out over the gas tank. It will require some force to remove the throughbolt, but it should come out with just hand pressure.

Remove the center [torque tube](#) mount.

Slightly lower the driveshaft. Remove the mass dampener halves from the welded on bracket of the rear [torque tube](#). The dampener is retained by one bolt and nut through the center of the dampener.

The original dampener (bolt) runs through a small captured

bushing/sleeve in the bracket. Remove the captured bushing from the bracket as the rear half of the new dampener will directly insert into the bracket hole.

The 3 kits vary in the number of washers included. No washers are included in the Aztek kit, one in the Rendezvous kit, and two in the kit for the mini-vans. For the mini-vans, the two washers are stacked together under the bolt head.

Install the new dampeners to the [torque tube](#) bracket. The threaded bushing is the rear most half. Install the front half of the dampener, then place (if required) the included washer(s) on top of the dampener, then place the bolt through the washer and dampener halves.

Tighten

Tighten the dampener retaining bolt to 55 N.m (41 lb ft).

Place the revised center [torque tube](#) mount in position above the torque tubes.

You MUST install the throughbolt with the head of the fastener facing the gas tank. In a collision, the rounded low profile of this fastener presents less chance of damage to the gas tank.

Install the [torque tube](#) to bracket through bolt with the TORX(R) head facing the gas tank.

Tighten

Tighten the [torque tube](#) to bracket throughbolt to 64 N.m (47 lb ft).

Raise the [torque tubes](#) slightly and install the four torque tube mount to body fasteners.

Tighten

Tighten the [torque tube](#) mount to body bolts to 55 N.m (41 lb ft).

Remove the supporting jackstand and lower the vehicle.



Part Number	Description
88964153	Kit – Dampener/Mount (Rendezvous)
88964152	Kit – Dampener/Mount (Aztek)
88964151	Kit – Dampener/Mount (Venture, Montana, Silhouette)

Zoom

Sized for Print

Parts Information

Warranty Information

Labor Operation	Description	Labor Time
F9711*	Clean Torque Tube Mount and Road Test	0.5 hr
F9702*	Torque Tube Bushing Kit – Install	0.8 hr
*This labor operation number is for bulletin use only. This number will not be published in the Labor Time Guide.		

Zoom

Sized for Print

For vehicles repaired under warranty, use the table.

GM bulletins are intended for use by professional technicians, NOT a "do-it-yourselfer". They are written to inform these technicians of conditions that may occur on some vehicles, or to provide information that could assist in the proper service of a vehicle. Properly trained technicians have the equipment, tools, safety instructions, and know-how to do a job properly and safely. If a condition is described, DO NOT assume that the bulletin applies to your vehicle, or that your vehicle will have that condition. See your GM dealer for information on whether your vehicle may benefit from the information.



WE SUPPORT
VOLUNTARY
TECHNICIAN
CERTIFICATION

Zoom

Sized for Print

Disclaimer

© 2010 ALLDATA LLC. All rights reserved.

[Terms of Use](#)